

MCIA **ACCEPTABLE** RECYCLING



PLASTICS #1 OR #2 ONLY



CHECK THE BOTTOM OF THE
PLASTIC FOR THE RECYCLING
NUMBER TO CONFIRM

RINSED & EMPTIED

**DO NOT USE
PLASTIC BAGS!**

ALUMINUM/STEEL CANS & GLASS BOTTLE



RINSED & EMPTIED

MIXED PAPER



PAPER, NEWSPAPER, MAGAZINE,
JUNK MAIL, CATALOGS

CORRUGATED CARDBOARD

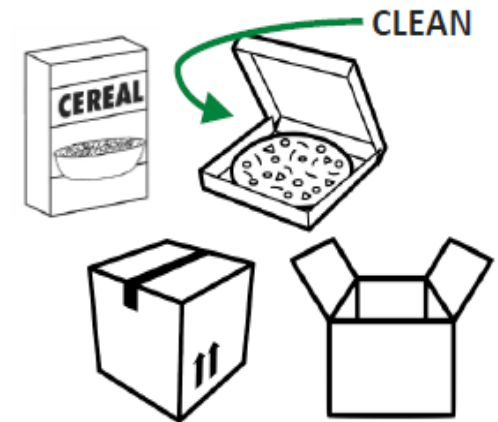

CEREAL BOXES, CLEAN PIZZA BOXES

FLATTEN & BUNDLE CARBOARD
SIZE LIMIT: 48" X 48" X 12"

**"WHEN IN DOUBT,
THROW IT OUT!"**

MCIA **NOT ACCEPTABLE** RECYCLING



Consolidated list of contaminated items provided by Solterra.
Placing these items in recycling will cause all of the resident's recycling to be **SKIPPED**.

CONTAMINATION LIST

EMPTY & RINSE ALL CONTAINERS – OR IT WILL NOT BE PICKED UP

PLASTIC GROCERY BAGS
PLASTIC LIDS OR CAPS
HARDBACK BOOKS
SCRAP METAL
PLASTIC 6-PACK HOLDER
SHREDDED PAPER
PAPER REAM WRAPPER
FROZEN FOOD OR ICE CREAM
CONTAINER
MIRRORS, CERAMICS OR PYREX®
LIGHT BULBS, PLATES, OR VASES
ELECTRICAL WIRES



DRINKING GLASSES OR
WINDOW GLASS
HAZARDOUS OR BIOHAZARDOUS
WASTE
TISSUES, PAPER TOWELS
OR NAPKINS
WAXED PAPER OR CARDBOARD
STICKERS OR ADDRESS LABEL SHEETS
STYROFOAM® OR PAPER TO-GO
CONTAINERS
GARDEN HOSES
NO WAXED CARDBOARD
CONTAINERS

MIDDLESEX COUNTY MEANS RECYCLE

MAINTAIN OUR LEADERSHIP AS THE TOP RECYCLING COUNTY



IT IS IMPORTANT THAT YOU KNOW WHAT CAN AND CANNOT BE RECYCLED IN YOUR MUNICIPALITY

- **PLASTIC BOTTLES WITH #1 CODE OR #2 CODE FOUND ON THE BOTTOM**
- ALUMINUM CANS
- GLASS BOTTLES AND JARS
- STEEL CANS
- NEWSPAPER
- MIXED PAPER (MAGAZINES, OFFICE PAPER, JUNK MAIL, CEREAL BOXES)
- CORRUGATED CARDBOARD (FLATTENED)



PETE



HDPE

Be a Better Recycler with Recycle Coach™

Personalized Calendar Reminders
Stop the Guessing
Help When You Need It

recyclecoach™



These common items are considered CONTAMINATION

Remember to Rinse & Empty All Containers

- NO GROCERY BAGS
- NO STYROFORM
- NO DIRTY PIZZA BOXES
- NO SHREDDED PAPER
- NO MIRRORS, LIGHTBULBS
- NO WAXED CUPS OR TAKEOUT CONTAINERS



81%
RECYCLING RATE
(NJDEP, 2015)

Highest County in
New Jersey for 8th Time



www.mciauth.com - www.middlesexcountynj.gov/recycle